

EUROPA 300 L

MULTIFUNCTIONAL APPLIANCE AIR/EXHAUST AIR HEAT PUMP WITH 300 L TANK

ORDER NUMBER: 110295

SERIES: EUROPA

TF MAX. 65°C

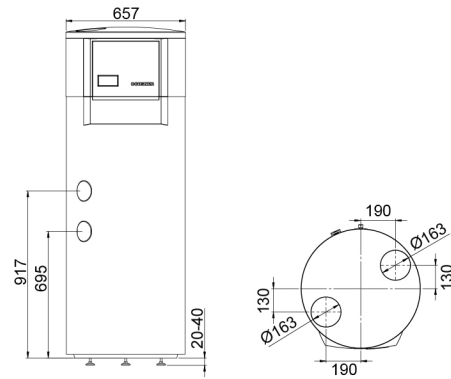

APPLIANCE DATA

Dimensions (diameter x height)	[mm]	650 x 1850
Type		Compact
Weight	[kg]	101
Electronic controller		Tiptronic Plus S (touchscreen)
Casing colour		Tiger white 29/11289/grey RAL 7016

SPECIFICATION

Phases/nominal voltage/frequency	[~]/[V]/[Hz]	1/220-240/50
Fuse protection (tripping curve "C")	[A]	13
Max. operating current	[A]	10.20
Starting current	[A]	18.00
Sound power/sound pressure level (at 1 m distance)	[dBA]	57.00 / 49.00

PERFORMANCE FIGURES (EN 16147 / A15)

Load profile		XL
Coefficient of performance (COP)		3.40
Heat-up time		8h 04min
Max. usable amount of water	[l]	379
Reference DHW temperature	[°C]	55.00
Average heating output	[kW]	1.96
Average power consumption	[kW]	0.50
SCOPw (VDI 4650-1:2016)		4.25

DHW TANK

Nominal capacity	[l]	300
Permissible operating pressure	[bar]	6
Material		Enamelled steel
Thermal insulation		Rigid PU foam (50 mm)
Sacrificial anode		1 x 1" magne- sium
Standby heat loss	[W]	89

ELECTRIC BOOSTER HEATER

Type		Electric immer- sion heater
Number	[pce]	1
Output	[kW]	1.5

BOOSTER HEATER COIL

Type		No coil
Permissible operating pressure	[bar]	
Permissible operating temperature of heating medium	[°C]	
Coil surface area	[m ²]	

CONDENSER

Type		Rollbond
Material		Aluminium
Max. refrigerant operating pressure	[bar]	25
Application range	[°C]	65
Heat transfer medium		Water

REFRIGERANT CIRCUIT

Refrigerant		R134a
Refrigerant charge	[kg]	1.10

COMPRESSOR

Type		Rotary piston
Output levels		1
Start type		Direct
Voltage/frequency	[V]/[Hz]	220-240 / 50

FAN

Type		Radial fan
Number	[pce]	1
Voltage/frequency	[V]/[Hz]	220-240 / 50
Power consumption	[W]	62
Max. operating current	[A]	0.30
Unrestricted air flow	[m ³ /h]	50-517
Infinitely variable		built-in
External pressure	[Pa]	80

EVAPORATOR

Type		Air/finned tube
Material		Copper/ aluminium
Number	[pce]	1
Defrost technology / frost protection shutdown		No / Yes
Max. refrigerant operating pressure	[bar]	27
Operating temperature min.	[°C]	+6
Operating temperature max.	[°C]	+40

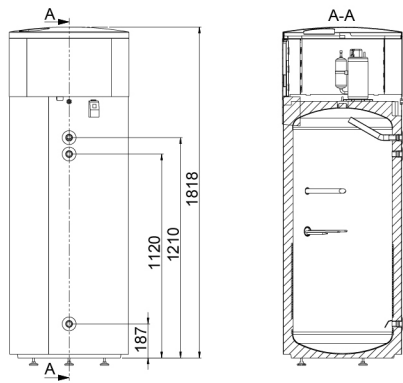

PRODUCT DATA **ErP: EUROPA 300 L**

LOAD PROFILE	A+ XL		
	COLDER	MEAN	HOTTER
η_{WH}	138	138	138
Annual power consumption [kWh]	1225	1225	1225
Temperature setting in delivered condition [°C]	52		
Sound power internal [dB]	57		
Smart grid ready (operation only in off-peak periods is possible)	Yes		

EXAMPLES OF APPLICATION



Exhaust air system (single-duct ventilation),
Exhaust air from bathroom, WC and kitchen to outside

Diagram for illustrative purposes only



Installation in laundry room
DHW heating from ambient air, drying of room

Diagram for illustrative purposes only



Cooling of pantry/storeroom

Diagram for illustrative purposes only

PERFORMANCE CURVES EUROPA 300 L

